

THE CREST COLLECTION



The Morris Home Plan

3 Bedrooms | 2½ Bathrooms | 1,690 Square Feet*



*Exterior design, square footage and product selections may vary by elevation.

The Crest Collection: Same heart. Smarter build. We've refined our most loved home plans to offer the same comfort and style with more efficient layouts and simplified construction. The result? Homes that stay true to what matters — with added value built in.

Dream. Build. Live.

PHONE: (800) 726-7397

WEB: VERIDIANHOMES.COM



VERIDIAN HOMES

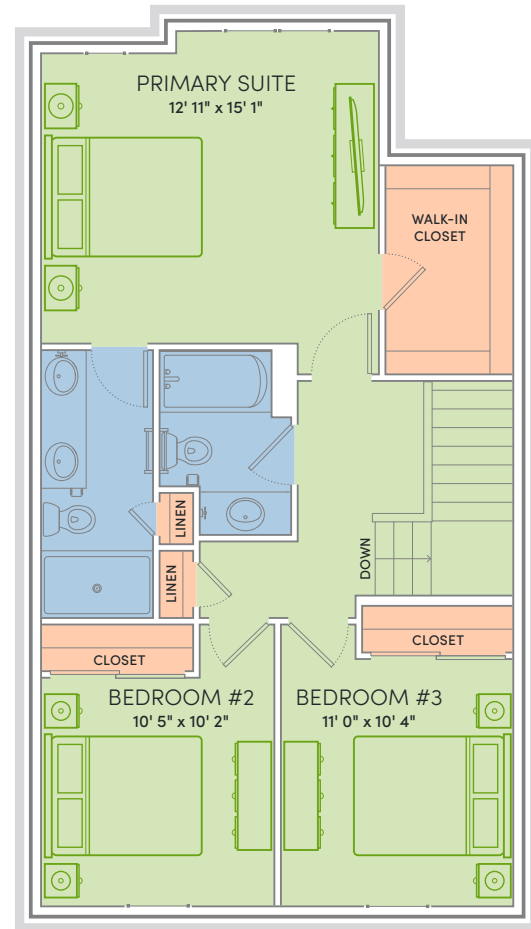
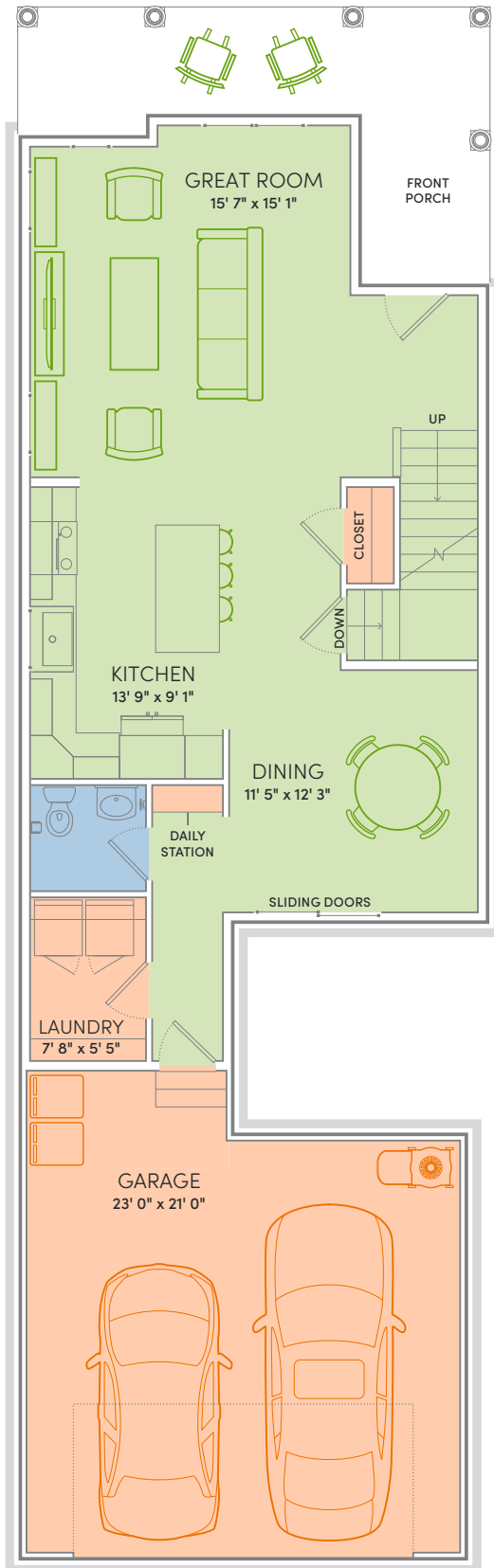

Floor Plan Features

- Open plan carriage lane home
- Quartz kitchen counters and large island
- First floor laundry adjacent to garage
- Daily station drop zone
- Primary suite with private bathroom and spacious walk-in closet
- Custom Auburn Ridge® cabinetry
- Energy expert certified
- Award-winning, high-performance home



Locally made in Columbus, Wisconsin, Auburn Ridge cabinets reflect over a century of craftsmanship, with timeless designs built to last.

Dream. Build. Live.

PHONE: (800) 726-7397

WEB: VERIDIANHOMES.COM

